

OnVUE Setup and Check-In



OnVUE Setup and Check-In

This automated process guides candidates through the entire setup and check-in process, and includes a guided transfer between testing (e.g., computer) and mobile devices. Once the automated process is complete, candidates are handed off to a live proctor.



ONVUE SETUP

BEGIN EXAM

DOWNLOAD + LAUNCH ONVUE

ENTER ONVUE ACCESS CODE

BEGIN CHECK-IN

EQUIPMENT AND NETWORK CHECKS

ENTER PHONE NUMBER

TRANSFER TO MOBILE DEVICE



MOBILE CHECK-IN

TAKE HEADSHOT

ID VERIFICATION

ENVIRONMENT CHECK

MOBILE CHECK-IN COMPLETE



FINAL STEPS

VIEW EXAM REMINDERS

TEST SECURE BROWSER

WAIT FOR PROCTOR

EXAM IS LAUNCHED

Begin exam

Pearson | VUE

It's time to check in!

Important notice to test takers [Learn more](#)

Description	Details	Order Information
Exam VUE-OP: VUE OP test Language: English Length: 60 minutes ⓘ	Appointment Friday, September 16, 2022 Check-in time: 9:45 AM America/Chicago - CDT Start time: 10:15 AM America/Chicago - CDT Check in	Order Number/Invoice Reschedule 0000-1307-2994 Cancel Registration ID 210638786 Status Purchased

VUE Testing Policies

System Requirements

Operating System: Windows 7 & Windows 7 Pro, Windows 8 & 8.1

- Note: Mac OSX are NOT supported at this time. Microsoft has ended support for Windows XP as of April 8, 2014.

Display: 1024 x 768 in 16-bit color (minimum resolution)

Internet Connection: Broadband (DSL, cable or LAN/WAN): 256 kbps down/256 kbps up

Internet Browsers: Internet Explorer 8, 9, 10, 11

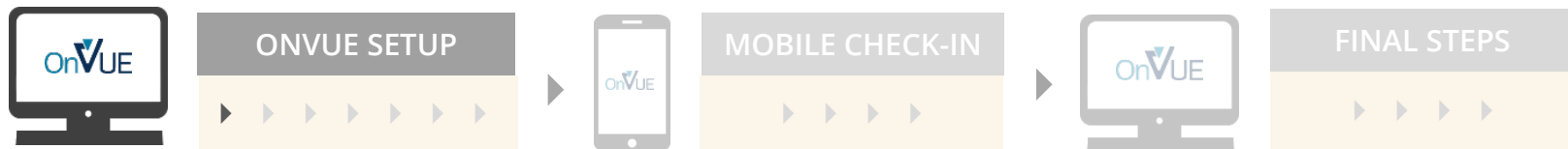

Download and launch OnVUE

The screenshot shows the OnVUE website interface. At the top left is the OnVUE logo, and at the top right is a language dropdown menu set to "English (US)". Below the header is a teal banner with a white alert box containing the text: "Alert! Work computers generally have more restrictions that may prevent a successful test. Ensure you are not behind a corporate firewall, and shut down any **Virtual Private Networks (VPNs)** or **Virtual Machines**." Below the banner are three white cards with teal borders, each representing a step in the process:

- 1. Copy Access Code**
Click **'Copy Access Code'**.
This code will authorize you to start the exam check-in process.
A text input field contains the code "133-585-280".
A teal button labeled "Copy Access Code" is at the bottom.
- 2. Download OnVUE**
Click **'Download'**.
A teal button labeled "Download" is at the bottom.
- 3. Run OnVUE**
Run the OnVUE application from your Downloads folder.

At the bottom of the page, there is a copyright notice: "Copyright 1996 - 2022 Pearson Education Inc. or its affiliate(s). All rights reserved." On the left and right sides of the screenshot, there are grey circular navigation buttons with white left and right arrow icons.

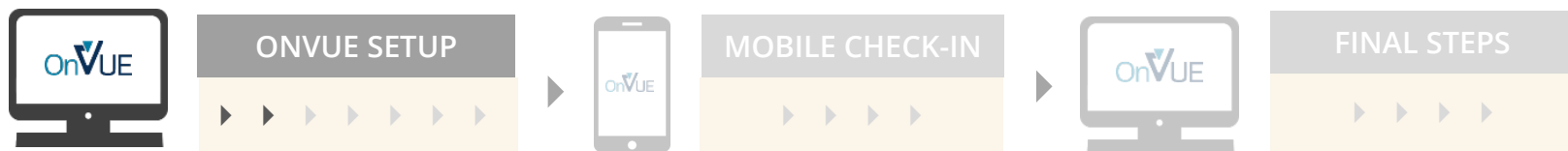

Enter OnVUE access code

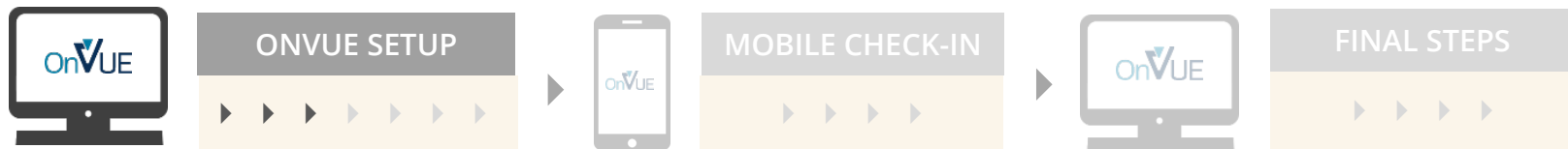
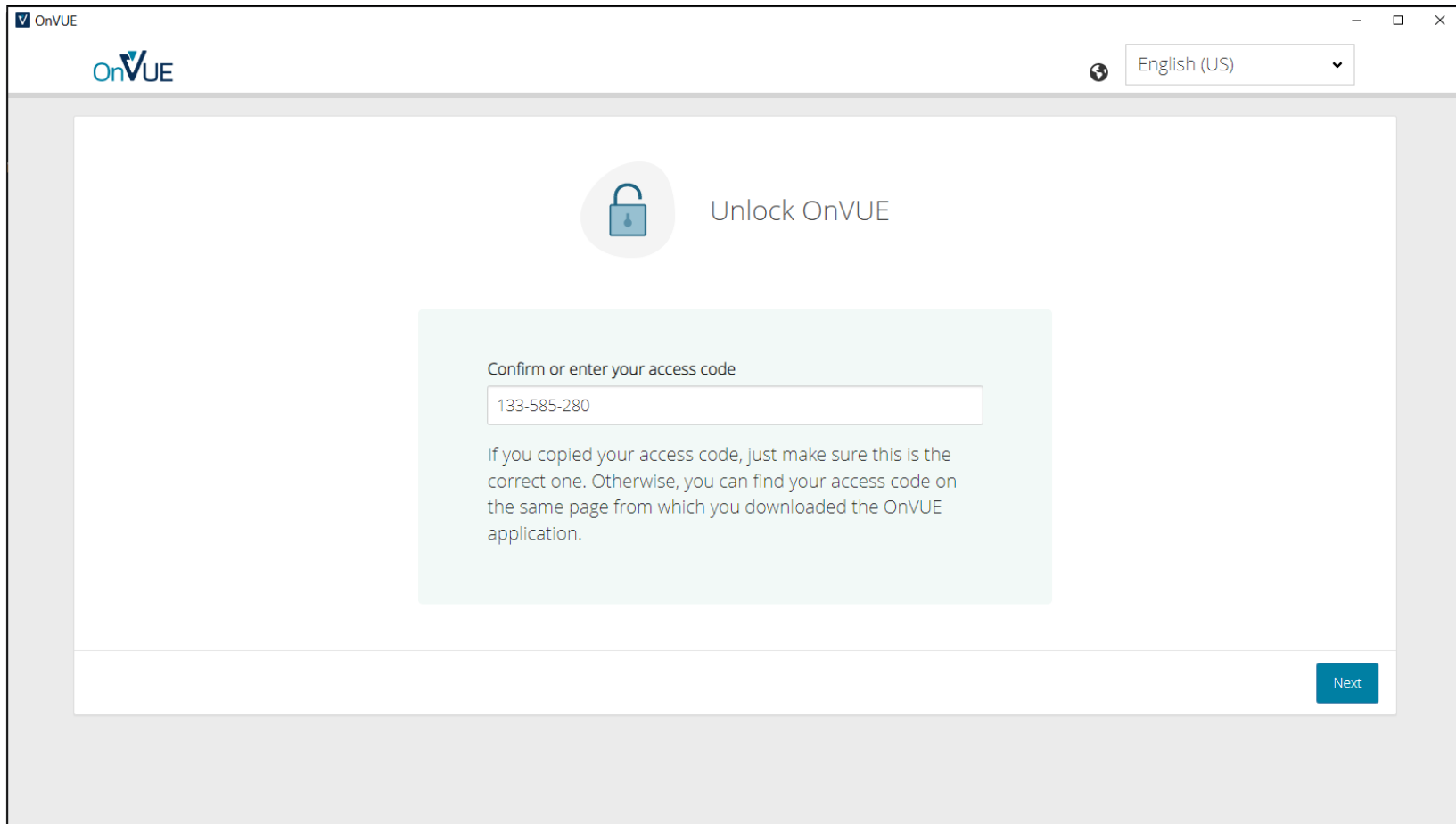

Begin check-in

OnVUE Access Code: 133-585-280

Check-In Process

What you need to take your exam

- Run diagnostics
- Enter phone number
- Yourself
- Your photo identification
- Your testing space
- Close all applications
- Accept exam rules

I am eighteen years of age or older. I am under eighteen years of age.

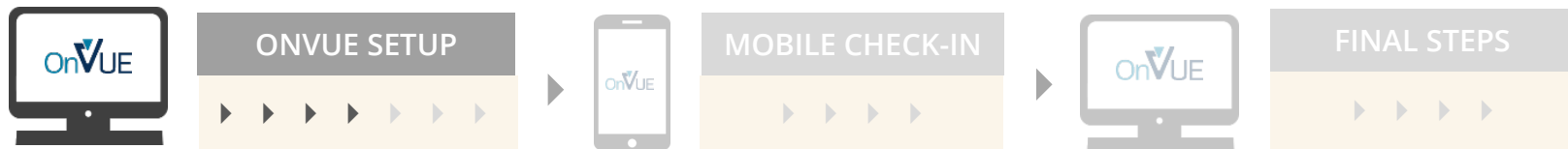

Diagnostics — equipment checks

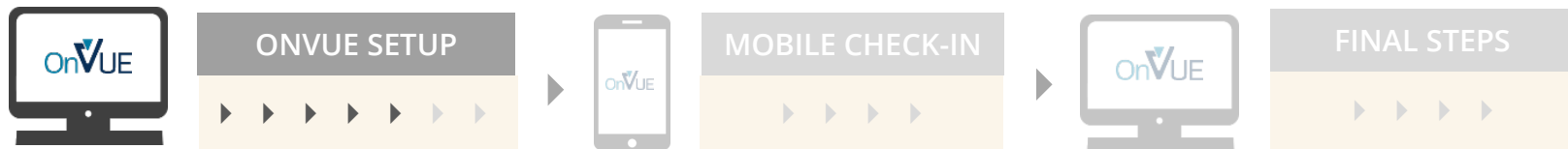
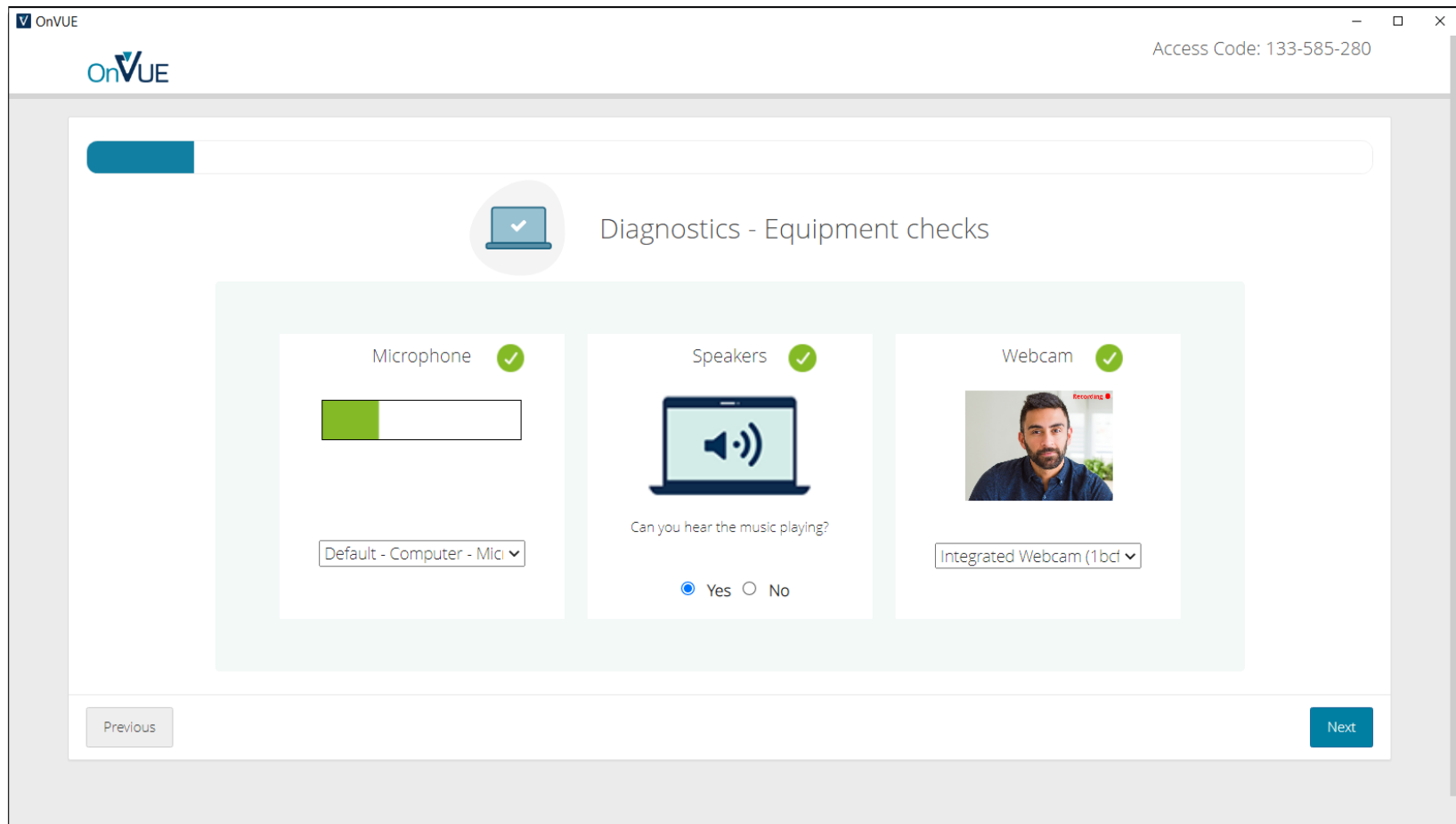

Diagnostics — network checks

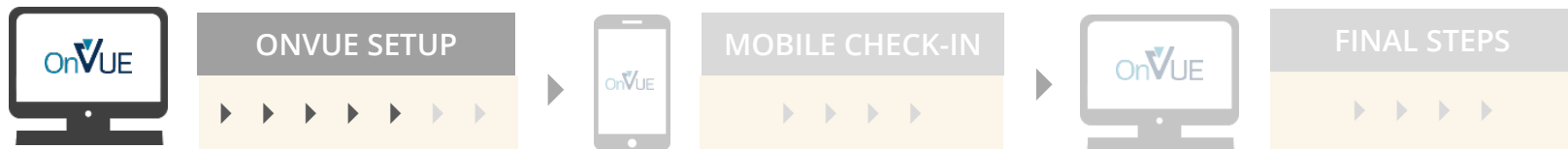
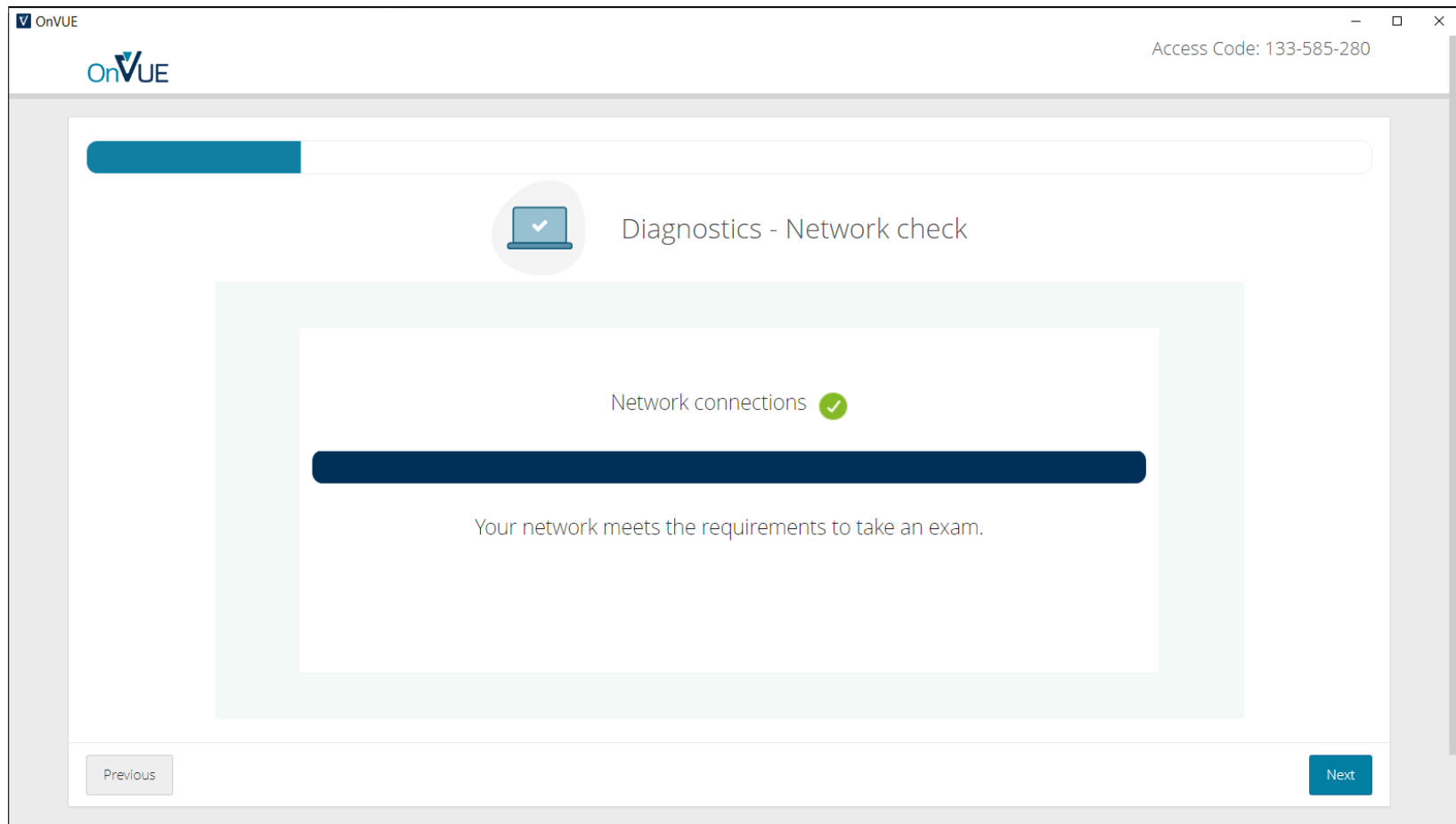

Enter phone number

OnVUE Access Code: 133-585-280

Enter your phone number

Enter the phone number you can be reached at during your check-in and exam.

+1 555-555-1234

Enter a phone number with country code, example U.S. +1; we only use this to contact you if there's an issue with check-in or exam delivery.

I do not have a phone available at this time.

Previous Next

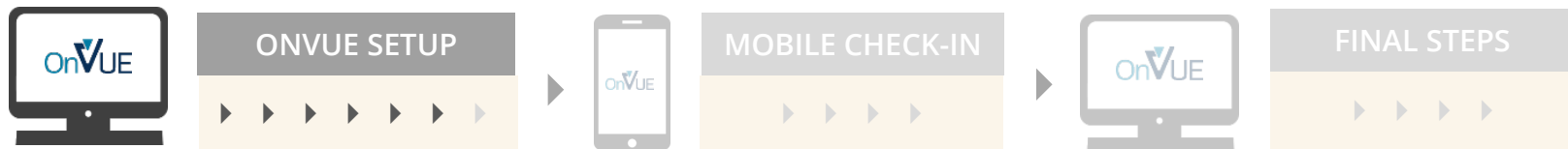

Transfer to mobile device

OnVUE Access Code: 133-585-280

Choose one of the options below to use mobile check-in

OPTION 1
Scan the QR code below with your phone's camera



OPTION 2
Receive a link via text

Phone number
+1 555-555-1234 Send

[View terms and conditions.](#)
 I accept the terms and conditions.

OPTION 3
Enter URL in your mobile web browser

1. Use your mobile phone's web browser to access
mobilectt.onvue.com
2. Enter this access code when prompted
133-585-280

Alternatively, you may check in using your [desktop computer](#)

Previous Refresh

After you've completed the check-in process, tap this Refresh button



Take headshot

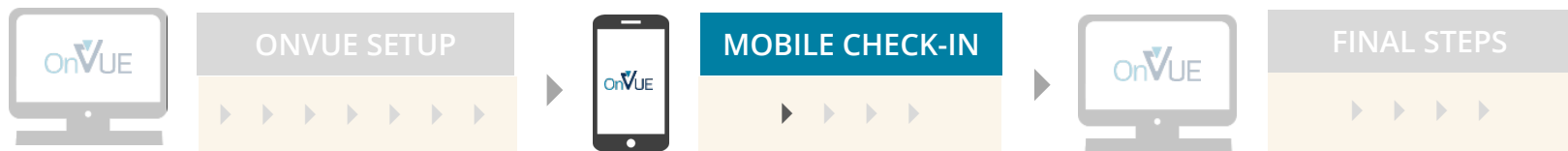
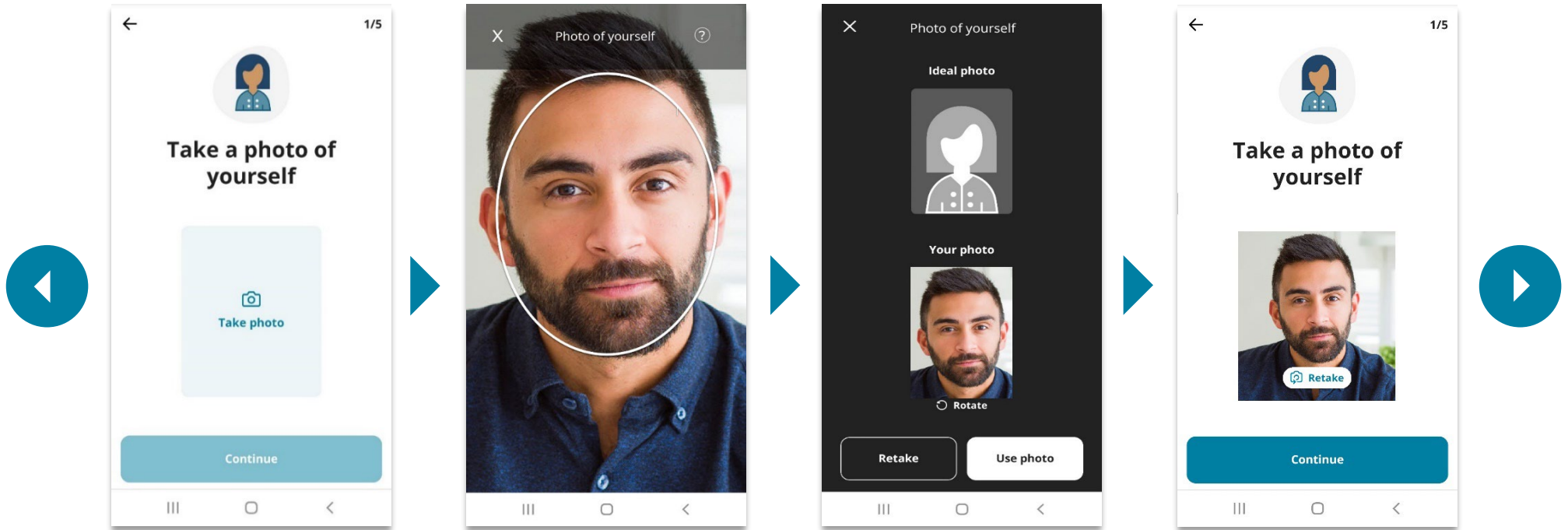

ID verification

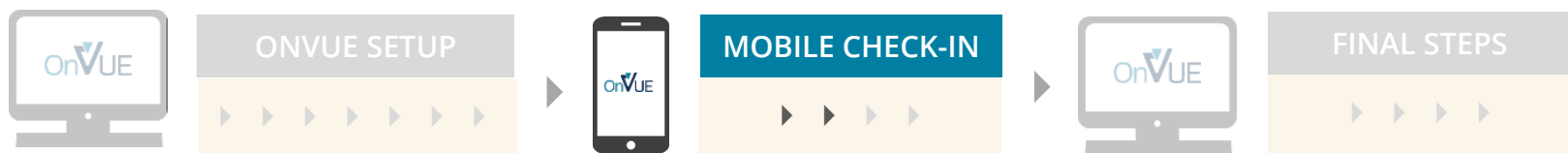
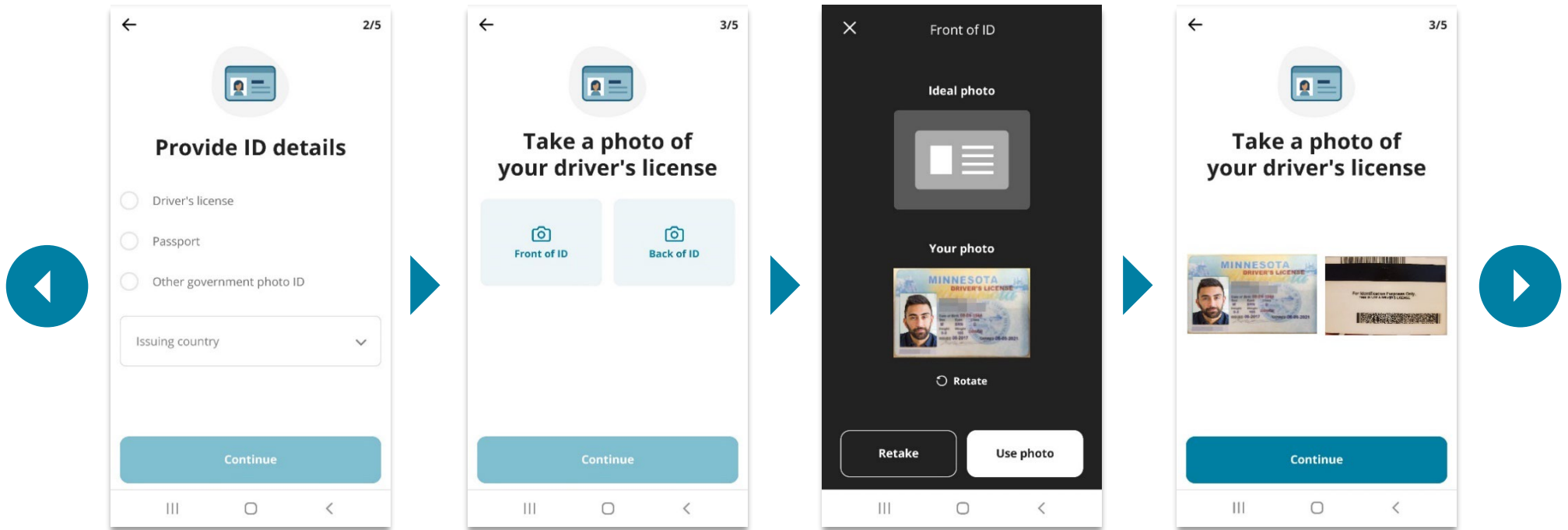

Environment check

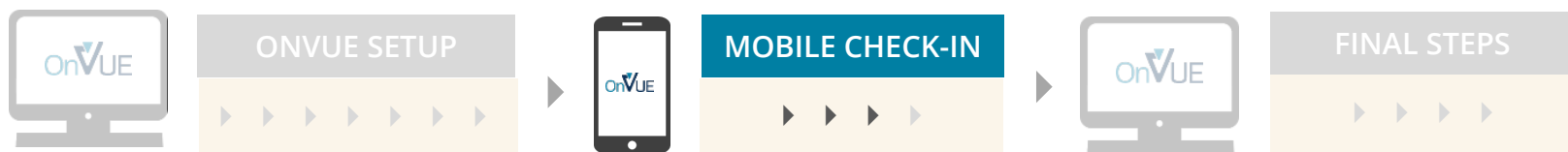
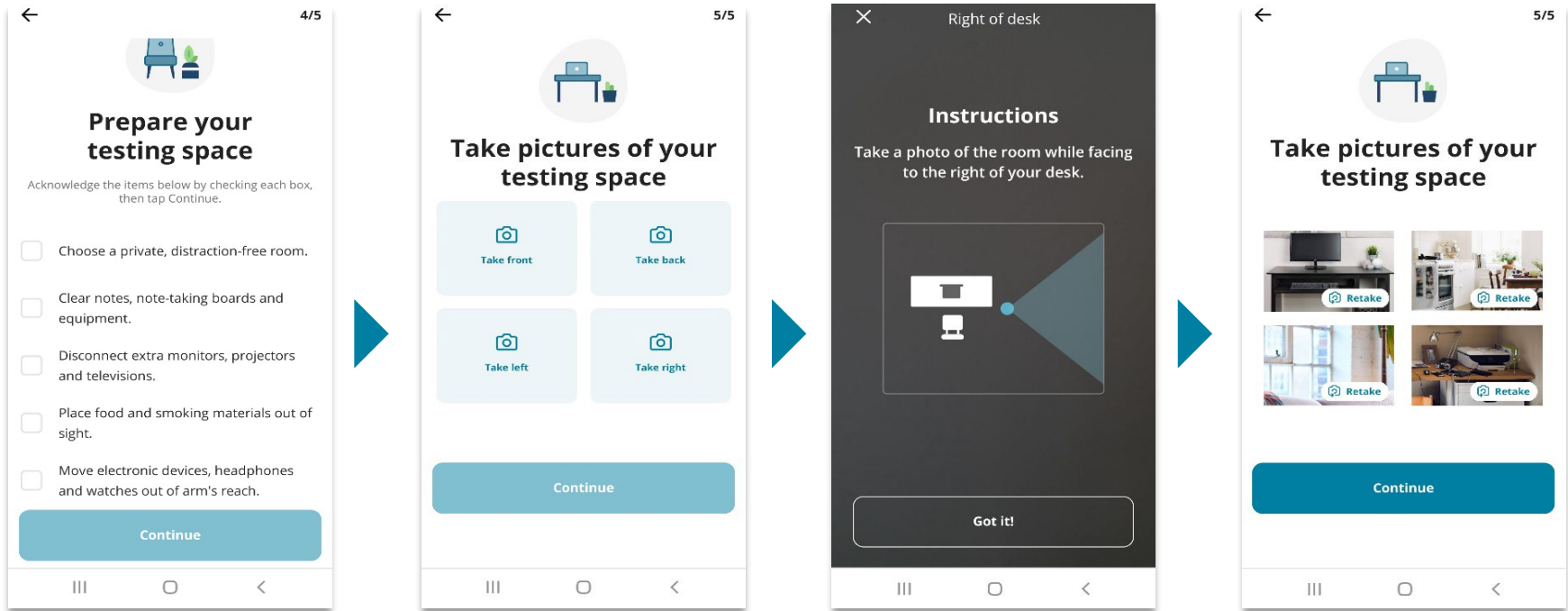

Mobile check-in complete

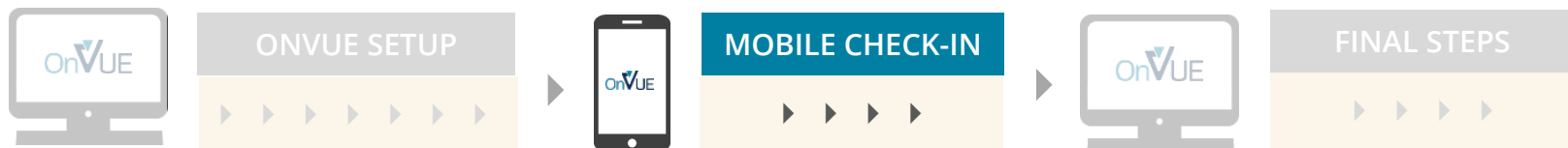
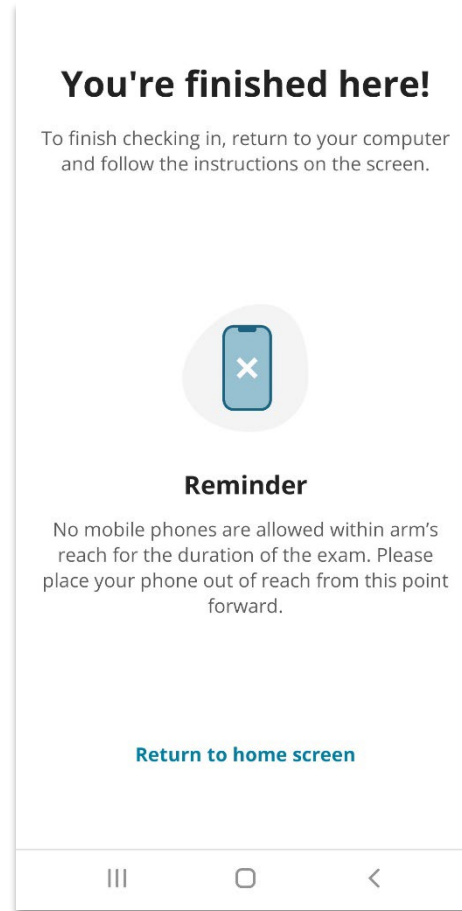

View exam reminders

OnVUE

Access Code: 133-585-280

Exam rules reminder

- No one is permitted in your testing area for any reason
- You must not leave your testing area for any reason
- You must not speak or mumble with your mouth covered
- You must not record or photograph any part of your test
- Mobile devices must remain out of arm's reach unless we contact you

I agree that breaking these rules will result in my exam being revoked

Previous

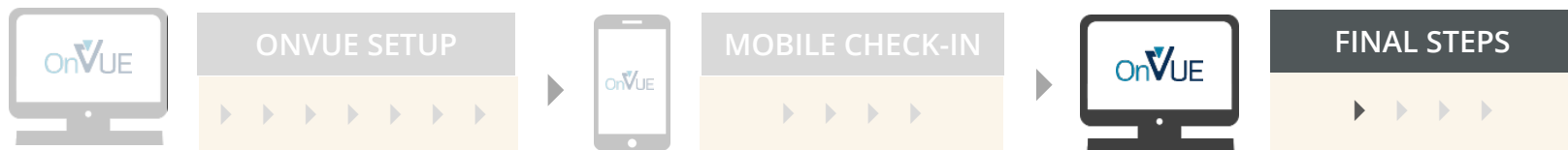

Test secure browser

OnVUE Access Code: 133-585-280

Secure browser test

1. Minimize risk of disruption by following the instructions below:
 - Close other applications by clicking the X button in the top-right corner of the application window.
 - Only one monitor is allowed. Please unplug any extra monitors.
2. Test to see if there are any issues that could prevent your exam from launching.

Test

Previous

Note: The Test/Retest buttons and related functions for checking open applications are available only for the secure browser used with Athena — Browser Edition. Candidates testing on ITS will simply see a message reminding them to close all applications except OnVUE.

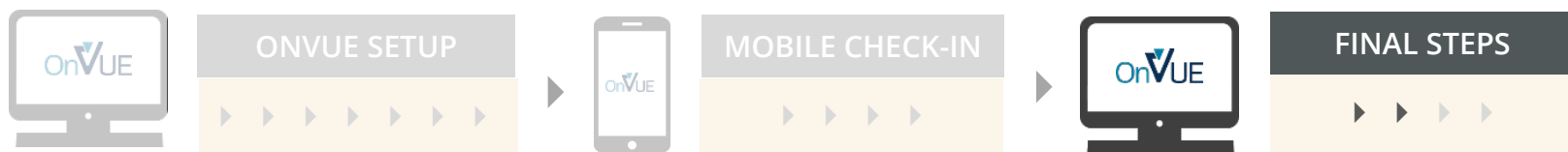

Wait for proctor

OnVUE

Access Code: 133-585-280

! You are almost done with the check-in process

You're in line to be greeted!

Don't worry: you'll still be able to take your exam, even if it's launched after your appointment time.

You can track your progress to the front of the line below.

Queue position: 5

This number will refresh in 60 seconds.

Recording

If you don't see your face here, we can't see you. Make sure your webcam is functional and not covered.

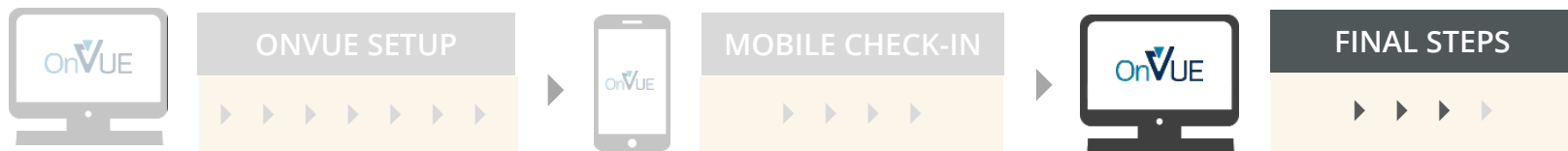

Exam is launched

The screenshot shows a web browser window titled "Vue Test Form - Vue Test Form" with a sub-header "Auto Mation". The interface includes a top navigation bar with a "V" logo, a "Recording" indicator with a red dot, a "Chat" icon, a "Whiteboard" icon, and an "Access Code" field containing "423-645-525".

The main content area is titled "Key Features" and contains two informational boxes:

Time Remaining 10:00	The time remaining will show in the top right corner of your screen. If you would like to hide the time, click on the icon of the clock. Click the icon again to show the time.
1 of 10	The current question number will also show in the top right corner of your screen. If you would like to hide the current question number, click on the icon to the left. Click the icon again to show the current question number.

Below the key features, the text reads: "Click **Next** to start the test."

A "Next →" button is located in the bottom right corner of the main content area.

